

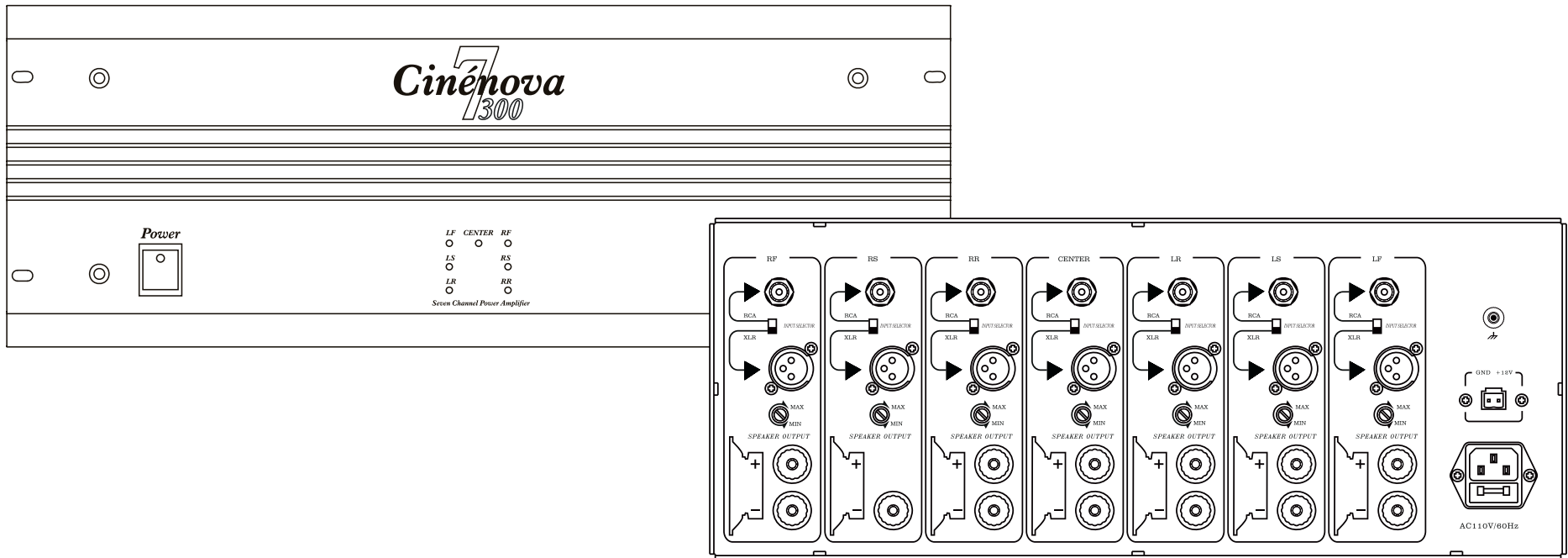

The Sound That Will Move You

Cinénova 7300

7 CHANNEL, CLASS AB AMPLIFIER



User Manual

Rated **#1**

Winner of Rave Award for **BEST AMPLIFIER** over \$3,000.00

“Potent combination of speed, grace and power”

“This amp brings new meaning to the phrase ‘gentle giant’”

- Home Theater Magazine

Table of Contents

| | |
|------------------------------------|----|
| Warranty Information..... | 3 |
| About Cinénova 7300 Amplifier..... | 4 |
| Important Safety Instructions..... | 4 |
| Front Panel Overview..... | 5 |
| Rear Panel Overview..... | 6 |
| Pre-setup..... | 7 |
| Specifications & Dimensions..... | 8 |
| Troubleshooting..... | 9 |
| For Your Records..... | 10 |
| Notes..... | 11 |

Cinénova
7
300



The Sound That Will Move You

Customer Technical Support
Tel: 510-732-1000
tech@earthquakesound.com

Earthquake Sound Corporation
2727 McCone Avenue
Hayward, CA 94545
Tel: 510-732-1000
Fax: 510-732-1095

©2021 Earthquake Sound Corporation. All rights reserved.

This document should not be construed as a commitment on the part of Earthquake Sound Corporation.

The information is subject to change without notice.

Earthquake Sound Corporation assumes no responsibility for errors that may appear within this document.



WARNING: Earthquake Sound products are capable of generating high sound pressure levels and strongly encourage you to exercise caution during operation. Long term exposures to high levels of sound pressure will cause permanent damage to your hearing. Sound pressure levels exceeding 85dB can be dangerous with constant exposure. Set your audio system to a comfortable loudness level. Earthquake Sound Corp. does not assume liability for damages resulting from the direct use of Earthquake Sound audio product(s) and urges users to play volume at moderate levels.

Five (5) Year Limited Warranty

Earthquake warrants the original purchaser that all Factory Sealed New Audio Products to be free from defects in material and workmanship under normal and proper use for a period of five (5) years from the date of purchase (as shown on the original sales receipt with serial number affixed/written on it). The five (5) year warranty period is valid only if an authorized Earthquake dealer properly installs the product and the warranty registration card is properly filled out and sent to Earthquake Sound Corporation. If a non-authorized party installs the product, a ninety (90) day warranty period will be applied.

(A) Five (5) years limited warranty plan coverage guidelines:

- First year: Earthquake pays for labor, parts, and ground freight (only in US mainland, not including Alaska and Hawaii) (shipping to us is not covered).
- Second, third, fourth & fifth year: Earthquake pays labor only. Customer must pay for parts and freight both ways.

(B) Warning:

Products (sent for repair) that are tested by Earthquake technicians and deemed to have no problem(s) will not be covered by the five (5) year limited warranty. Customer will be charged a minimum of one (1) hour of labor (at the ongoing rates) plus shipping charges back to customer.

Each product sent for repair must be packaged in its original packaging.

Otherwise, there will be repackaging charge in addition to labor, parts and shipping charges.

(C) Earthquake will repair or replace - at our option - all defective products/parts subject to the following provisions:

- Defective products/parts have not been altered or repaired by other than an Earthquake factory-approved technician.
- Products/parts are not subjected to negligence, misuse, improper use or accident, damaged by improper line voltage, used with incompatible products or have its serial number or any part of it altered, defaced or removed, or have been used in any way that is contrary to Earthquake's written instructions.

(D) Warranty Limitations:

Warranty does not cover products that have been modified or abused, including but not limited to the following:

- Damages to cabinet/casing finish due to misuse, abuse or improper use of cleaning materials/methods.
- Fading and or deterioration of speaker components & finish due to improper exposure to elements.
- Bent amplifier casing, damaged finish on the casing due to abuse, misuse or improper use of cleaning material.
- Burnt tracers on PCB.
- Product/part damaged due to poor packaging or abusive shipping conditions.
- Subsequent damage to other products.

A warranty claim will not be valid if the warranty registration card is not properly filled & returned to Earthquake with a copy of the sales invoice.

(E) Service Request:

To receive product service, contact Earthquake service department at (510) 732-1000 and request an RMA number (Return Material Authorization). Items shipped without a valid RMA number will be refused. Make sure you provide us with your complete/correct shipping address, a valid phone number, and a brief description of the problem you are experiencing with the product. In most cases, our technicians might be able to resolve the problem over the phone; thus, eliminating the need to ship the product.

(F) Shipping Instructions:

Product(s) must be packaged in its original protective box(es) to minimize transport damage. Shipper claims regarding items damaged in transit must be presented to carrier. Earthquake Sound Corporation reserves the right to refuse improperly packed product. Original sales receipt must accompany product returned for service. We encourage you to include with the package a written description of the problem.

Ship product to: Earthquake Sound Corp. 2727 McCone Avenue, Hayward, CA 94545. Phone: (510) 732-1000. You are responsible for the cost of shipping the product to Earthquake Sound Corporation.

(G) Disputes Resolution:

All disputes - between clients and Earthquake Sound Corporation - resulting from the five (5) years limited warranty policy must be resolved according to the laws & regulations of the county of Alameda -California.

Product Registration

This Cinénova 7300 Power Amp can be registered by returning the Product Registration card attached to this manual. Please also retain the sales receipt which represents proof of purchase and helps expedite warranty issues.

Your Cinénova 7300

Thank you for purchasing this Cinénova 7300 state of the art multi-channel amplifier. This amplifier is designed to surpass your expectations and satisfy your audiophile needs for music and movie enjoyment. The Cinénova 7300 is conceived to reproduce “true to life” music as it was originally recorded, without tempering, coloration, or compression. Created in the image of its larger brethren, the Cinénova 7300 is an uncompromising design built upon massively over-specified components. Using power dense transformers exceeding 2800 VA and completely self-contained output blocks, the Cinénova 7300 is a septomonaural amplifier. Completely separate output blocks are largely unheard of in this class of amplifier, but with Earthquake’s enduring strive for quality and excellence there simply was no other way. Designs that share a common motherboard inherently lack the fidelity of true separate designs. The Cinénova 7300 is ready to take on even the heaviest of speaker and hold it in an iron grip. Large vertically-ripped individual heat sinks efficiently release heat and ensure that your show goes on no matter the intensity. From the loudest crescendo to the finest syllable, the Cinénova 7300 will remain composed and in control. Enjoy the unique ownership experience of this Cinénova amplifier that was designed by a brilliant mind and built with loving hands.

Constructing a Cinénova is a fun process. From hand assembling, calibrating, burn testing, and packaging, every step is conducted with love for details and hunger for perfection. We enjoyed building your Cinénova and we know you will feel the same using it.

From our hands to your ears... Thank you.

Important Safety Instructions

- Read these instructions in their entirety.
- Store this manual and packaging in a safe place.
- Heed all warnings.
- Follow instructions (do not take short cuts).
- Do not use this apparatus near water.
- Clean only with a dry cloth.
- Do not block any ventilation openings. Install in accordance with the manufacturers instructions.
- Do not install near any heat sources such as radiators, heat registers, stoves, or other apparatuses that produce heat.
- Do not defeat the safety purpose of the polarized or grounding-type plug. A polarized plug has two blades with one wider than the other. A grounding-type plug has two blades and a third grounding prong. The wide blade or the third prong is provided for your safety. If the provided plug does not fit into your outlet, consult an electrician for replacement of the obsolete outlet.

- Protect the power cord from being walked on or pinched, particularly at plugs, convenience receptacles, and the point where they exit from the apparatus.
- Only use attachments & accessories specified by the manufacturer.
- Use only with a cart, stand or table that can support the product weight, NOT RACK MOUNTABLE. Use caution when moving or positioning your rack or cart so that it will not tip over, which may cause serious injury to you or your products.
- Unplug this apparatus during a lightning storm or when unused for long period of time.
- Refer all servicing to qualified service personnel. Servicing is required when the apparatus has been damaged in any way such as: power-supply cord or plug is damaged, liquid has been spilled or objects have fallen into the apparatus, the apparatus has been exposed to rain or moisture, does not operate normally, or has been dropped.
- To reduce the risk of fire or electric shock, do not expose this apparatus to rain or moisture.

The following symbols are used in this document:



Appears on the component to indicate the presence of uninsulated, dangerous voltage inside the enclosure – voltage that may be sufficient to constitute a risk of shock.

CAUTION

Calls attention to a procedure, practice, condition or the like that, if not correctly performed or adhered to, could result in injury or death.

WARNING

Calls attention to a procedure, practice, condition or the like that, if not correctly performed or adhered to, could result in damage to or destruction of part or all of the product.

Note:

Calls attention to information that is essential to highlight.

Cinénova 7300 Front Panel Overview

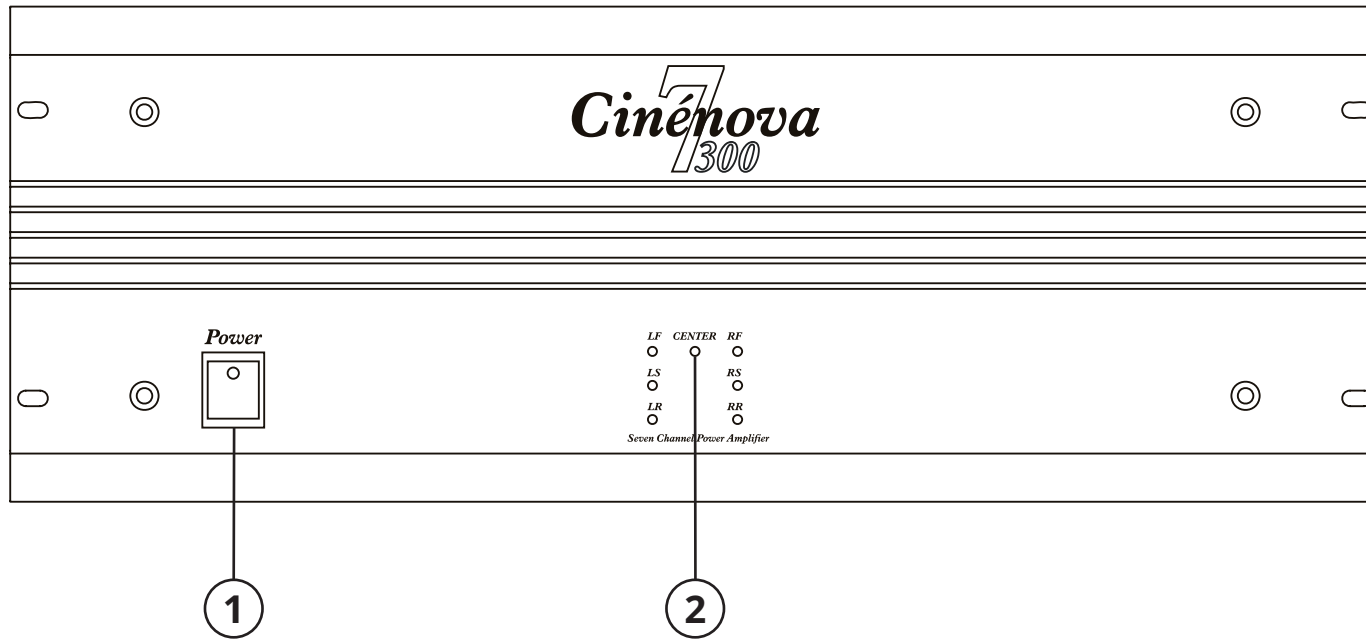

1. Master Power Switch:

Turns the current to the amplifier ON or OFF manually. When turning on the amplifier via a 12VDC source the switch must be in the OFF position.

Additionally when adding or removing 12VDC connections or any other connections the main power circuit breaker needs to be in the off position. This will help prevent any surges that could damage your products or cause bodily injury.

2. Peak LED Indicators:

The Cinénova 7300 is equipped with seven LED indicators on the front panel that should remain unlit. These LEDs indicate the operating status of each corresponding channel. If an LED or all LEDs remain lit continuously, the amplifier is clipping that channel and the volume should be turned down immediately to prevent damage. It is ok for the LED to flicker but it should never remain on continuously.

Cinénova 7300 Rear Panel Overview

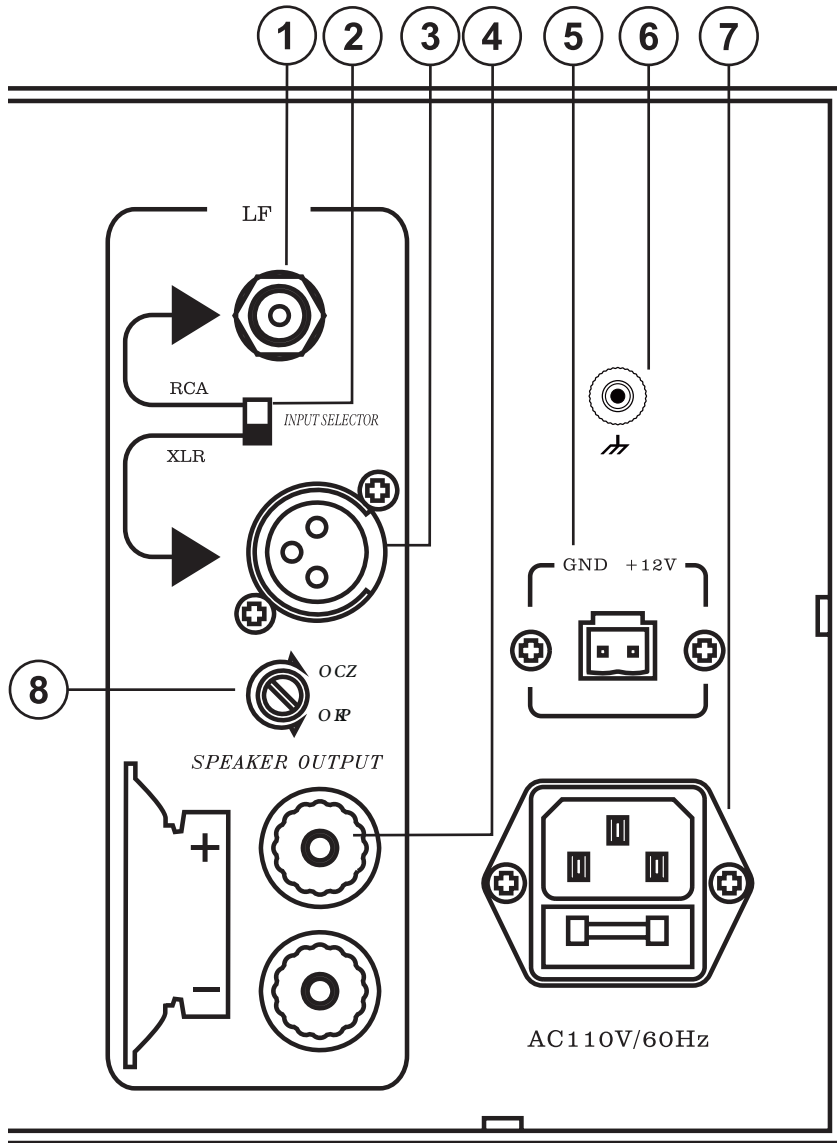

1. RCA Input:

Accepts low-level signal from any source, such as a processor or receiver. From 0.4 Vac up to 6 Volt AC.

2. Input Selector:

To maintain signal integrity Cinénova 7300 provides you with an “Input Selector Switch”. This gives you (installer) the option to select between RCA or XLR inputs.

3. Fully Balanced XLR Inputs:

We recommend the use of fully balanced XLR inputs in cases when the distance between the Cinénova amplifier and the audio source is excessive and susceptible to noise interference.

4. Gold Plated Speaker Output Binding Posts:

We recommend that you use a high quality wire constructed of fine, multi-strand copper 10-gauge and up. Wire with a gauge of 16 may be used for short runs of less than twenty feet. We do not recommend that you use any wires with a gauge equivalent of 18 or higher due to the power loss and performance degradation.

5. 12VDC Trigger:

In order for the Cinénova 7300 Turn-ON to be controlled via another source, connect the 12VDC trigger input to the 12VDC source output (polarity is not an issue). From your source, 12VD should have over 20mA. Then set the manual power switch to OFF and the circuit breaker to ON. Now any time the Cinénova detects an incoming 12VDC signal it will automatically power on.

6. Ground Wire Binding Post:

This binding post is used for connecting a ground wire from the amplifier to your AV receiver. We recommend that you use a high quality wire constructed of fine, multi-strand copper 10-gauge and up.

7. AC Input Connector:

IEC Power Receptacle

8. Input Sensitivity:

Input selector gain set is based on your processor output voltage. The table shown below reflects the signal required from your processor if you were to set this gain based on the displayed position.

| | | | | | | |
|-----------------------|-----------------------|--------------------|---------------------|---------------------|---------------------|----------------------|
| | | | | | | |
| 7.3 VAC 10 O'CLOCK | 1.6 VAC 12 O'CLOCK | 1 VAC 1 O'CLOCK | 570 mV 2 O'CLOCK | 480 mV 3 O'CLOCK | 389 mV 6 O'CLOCK | 373 VAC 7 O'CLOCK |

Getting Started With The Cinénova 7300

Confirm the voltage setting of the amplifier. It must match the voltage in your home. The amp is set by factory to either 120V or 240V. Check above the circuit breaker for this information.

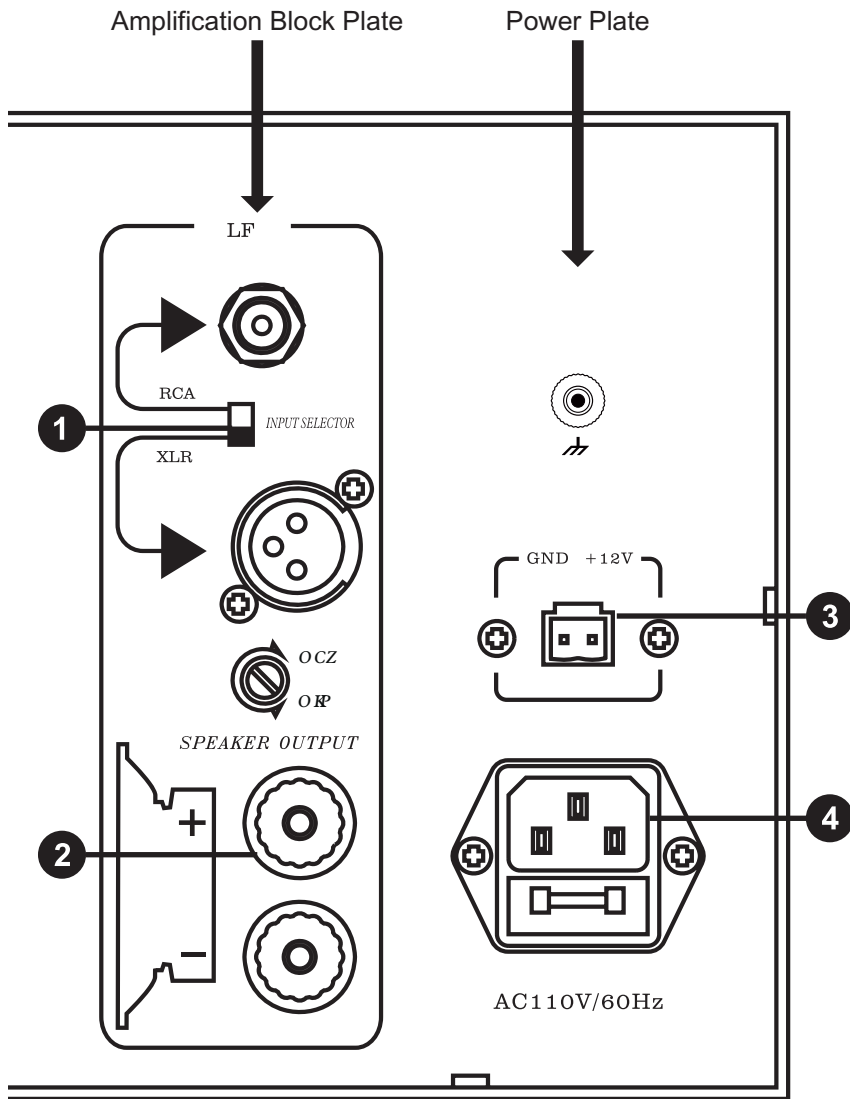

1) INPUT SELECTION

Set the input control to either RCA or XLR. This tells the amp which input type will be used.

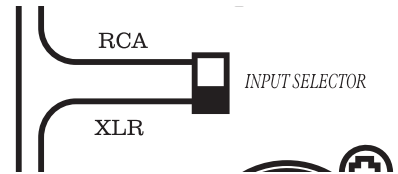

2) SPEAKER CONNECTIONS

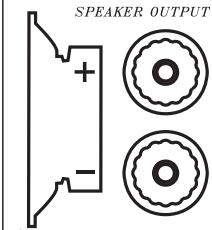

A pair of binding posts is provided for each channel. These posts accept bare wire, spade lugs & banana type plugs. If bare wire is used then strip approximately 1/2 inch to 3/4 inch of insulation from the end of each wire and carefully twist the strands of each conductor together. Then insert.

3) 12VDC WHEN APPLICABLE

If you plan to power the Cinénova 7300 using an external source, then you will need to plug the source into the 12VDC Trigger.

When using this feature the main power switch must remain in the OFF position at all times.

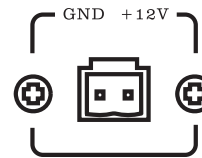

4) PLUG IN POWER CORD

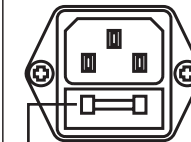

Plug the AC power cord into the amp first then into the wall outlet. Make sure it is firmly connected.

CAUTION

The fuse holder is located directly under the power socket. It contains one extra 15 ampere, 250V fuse.

To access the fuse holder, make sure your Cinénova is turned off and unplugged from both the wall outlet and the amplifier's power socket. Place a flat head screwdriver in the groove on the top of the fuse holder and simply pry off the fuse holder.

Cinénova 7300 Specifications & Dimensions

| | |
|---|--|
| MODEL | Cinénova 7300 |
| Number of Channels | 7-channels |
| Power Rating Per Channel (All Channels Driven) | (8-ohm load) Rated: 180 WRMS ¹ (4-ohm load) Rated: 300 WRMS ¹ (2-ohm load) Rated: 550 WRMS |
| Input Impedance | - RCA: 28 kΩ - XLR: 48 kΩ |
| Input Sensitivity | 30 kΩ |
| Frequency Response | up to 30kHz ±0.1dB |
| Total Harmonic Distortion + Noise | 0.003% at 1 watt |
| Signal to Noise Ratio (A-Weighted) | Greater than -111 dB |
| Cross Talk / Channel Separation | Greater than -110 dB from 17Hz–40kHz |
| Slew Rate | 60V/microsecond |
| Damping Factor | 1600 at 8-Ohm |
| DC Output Offset | 0.004 |
| Power Requirement | 120 VAC/240 VAC Factory Preset |

| |
|---|
| Chassis Dimensions (H x W x D) |
| 7" x 17" x 17.12" (178mm x 432mm x 435mm) |
| Front Plate Dimensions (H x W) |
| 7" x 19" (178mm x 483mm) |
| Mounting Plate Dimensions (H x W) |
| 4" x 18.37" (102mm x 467mm) |
| Net Weight |
| 80 lbs / 36.3 kgs |
| Shipping Weight |
| 93 lbs / 42 kgs |

¹ Adequate ventilation may be required and 240VAC/20 Ampere circuit is recommended.

¹ Depending on listening habits and ambient temperatures, 4-ohm and 2-ohm uses might require additional cooling.

Troubleshooting The Cinénova 7300

Peak LEDs “ON” Constantly

It is normal when running the amplifier to full power that the LED's flicker. If the LED's are on constantly without flickering (solid orange) it means that the amplifier output is clipping. Reduce volume level to prevent damage to speakers or amplifier.

Humming Noise From Speakers

Often humming noise is emanating from equipment that have their ground prong broken. To isolate this problem:

- a) With the amplifier OFF, unplug all RCA's connected to the amp.
- b) Turn on amp and listen to speakers. If buzz has changed or reduced in level, then the problem is coming to the amp from another source. The rest of the hum you hear is normal and related to the fact that the RCA's are open ended.
- c) The above step should isolate your problem: star-ground all components, except amplifier, by daisy-chaining a thin wire from the processors chassis to all sources connected to it.

Maintenance

The following maintenance should be performed routinely:

- Clean the exterior surfaces of the unit with a soft, dry, lint-free cloth.
- Do not use alcohol, benzene, acetone-based cleaners, or strong commercial cleaners.
- Do not use a cloth made with steel wool or metal polish.
- If the unit is exposed to a dusty environment, a low-pressure blower may be used to remove dust from its interior & exterior.

Circuit Protection

The Cinénova 7300 is protected with optical short circuit protection. If it is tripped, the shorted channel will mute and reset every 7 seconds. If fault remains, it will stay in mute mode. We recommend to swap the speaker with a guaranteed working speaker and see if the channel works.

If Problems Persist

Contact Earthquake Sound Technical Service
Phone: 1-800-576-7944 or 510-732-1000
Email: tech@earthquakesound.com

For Your Records

Date of Purchase: _____

Authorized Dealer/Installer Info:

Name: _____

Address: _____

Phone: _____

Serial Number:

Notes

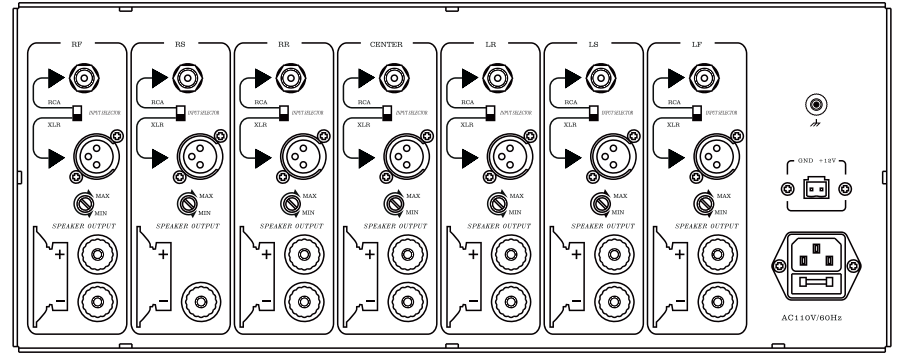
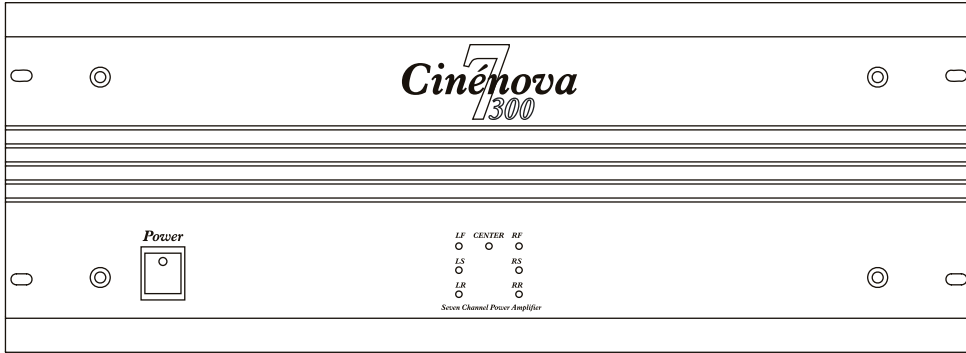



The Sound That Will *Move* You

Earthquake Sound reserves the right to amend details of the specifications without notice.

© Copyright Earthquake Sound Corporation

Earthquake Sound Corporation

2727 McCone Avenue, Hayward CA, 94545

Phone: (510) 732-1000 U.S. Toll Free: (800) 579-7944 Fax: (510) 732-1095