

## iWoofers™ Optimization Guide

This document is designed to show you how to optimize the iWoofers™ app to Earthquake MiniMe line of subwoofers. As you are well aware, Earthquake sound subwoofers use the patented Symmetrically Loaded Audio Passive System or SLAPS technology. This passive radiator allows Earthquake to tune the enclosure below audible i.e. 20Hz” or where no other subs

have gone before” and so, the default setting of iWoofers™ is 25 Hz high pass filter. while this is a good setting for other brand woofers (to protect them from failures) Earthquake subwoofers operate well below the 25Hz frequencies. These changes to settings allow for the iWoofers™ to go down to 16Hz it is a must use setting to match Earthquake subwoofers.

1. After pairing to the subwoofer, using iWoofers (free) or iWoofers™ Pro (\$5) go to Xover setting (before doing Room correction)



2. Insert an EQ boost as seen below. Tap the PEQ On button to create a band shown as a dotted red line. Double tap or press and hold a band for more than 1 second to select it. Once the band is selected you can slide it left or right to change frequency and up or down to control the gain. Use two fingers in a zoom in or zoom out fashion to change the Q factor. Slide the band over to the left in the 20Hz position.

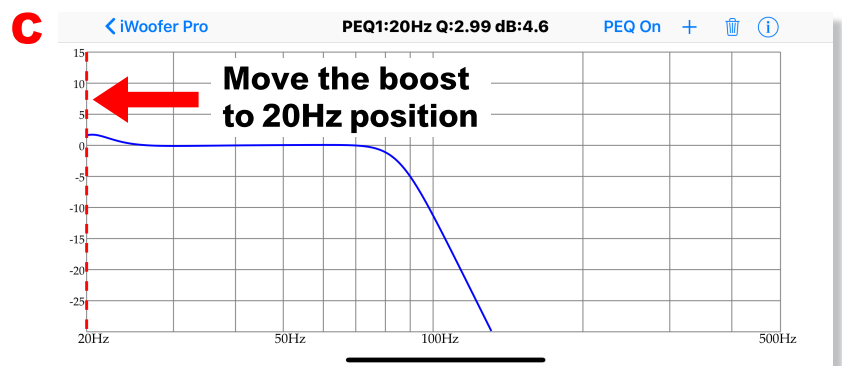
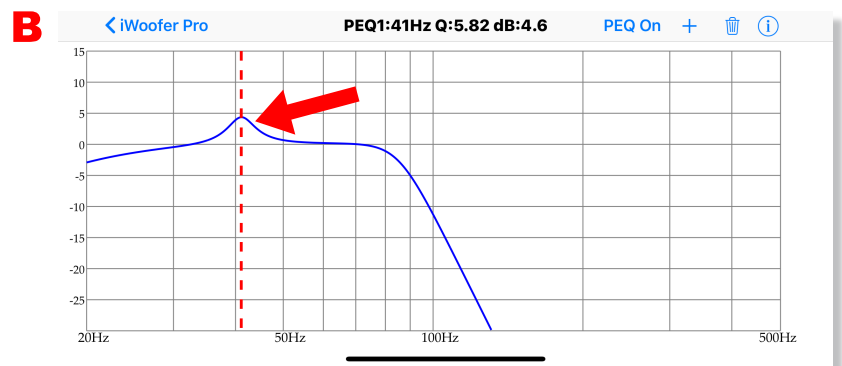
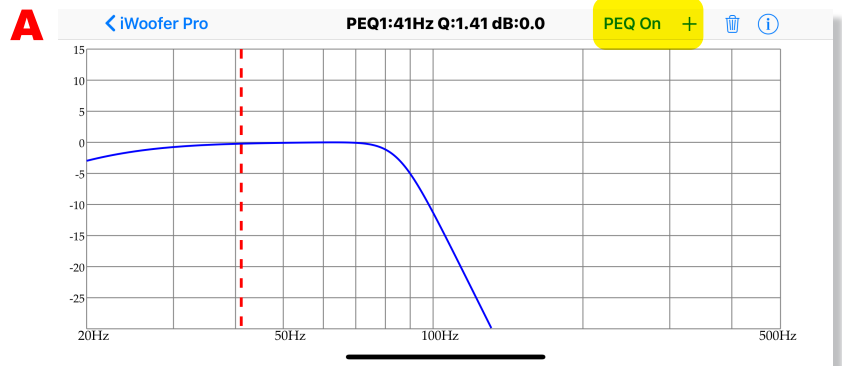

3. Scroll down to Limiter Compression Control and activate it. Then go to settings and match what is shown in red in the image to the right.

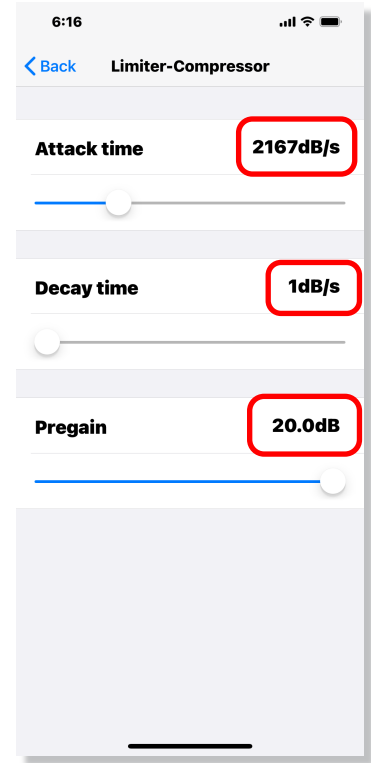
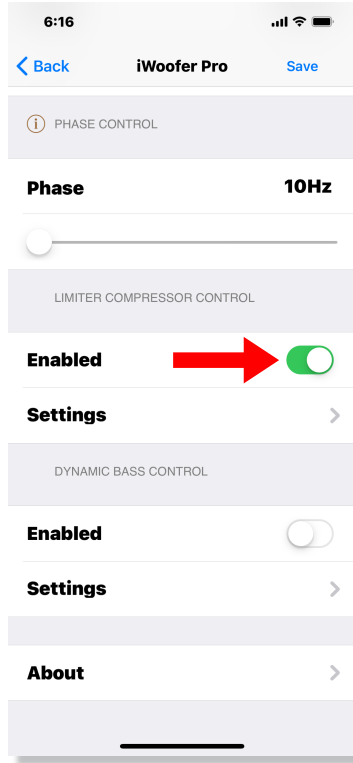
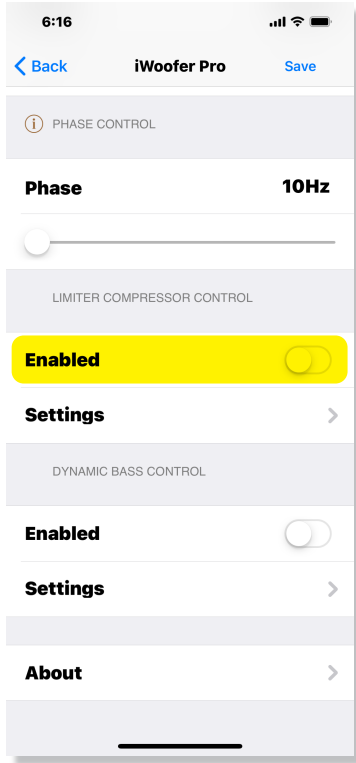

4. Navigate to Options and then HW Controllers and make sure that the HP filter is off and the LP filter is on as shown below. Finish by syncing your file to the MiniMe DSP subwoofer and also save the file to your mobile device. Your MiniMe DSP subwoofer is now optimized.

